

**SAFETY HEALTH AND ENVIRONMENTAL ISSUES**

IN ADDITION TO THE RISKS AND HAZARDS, NORMALLY ASSOCIATED WITH THE TYPES OF WORK DETAILED ON THIS DRAWING, YOUR ATTENTION IS DRAWN TO THE FOLLOWING RESIDUAL RISKS

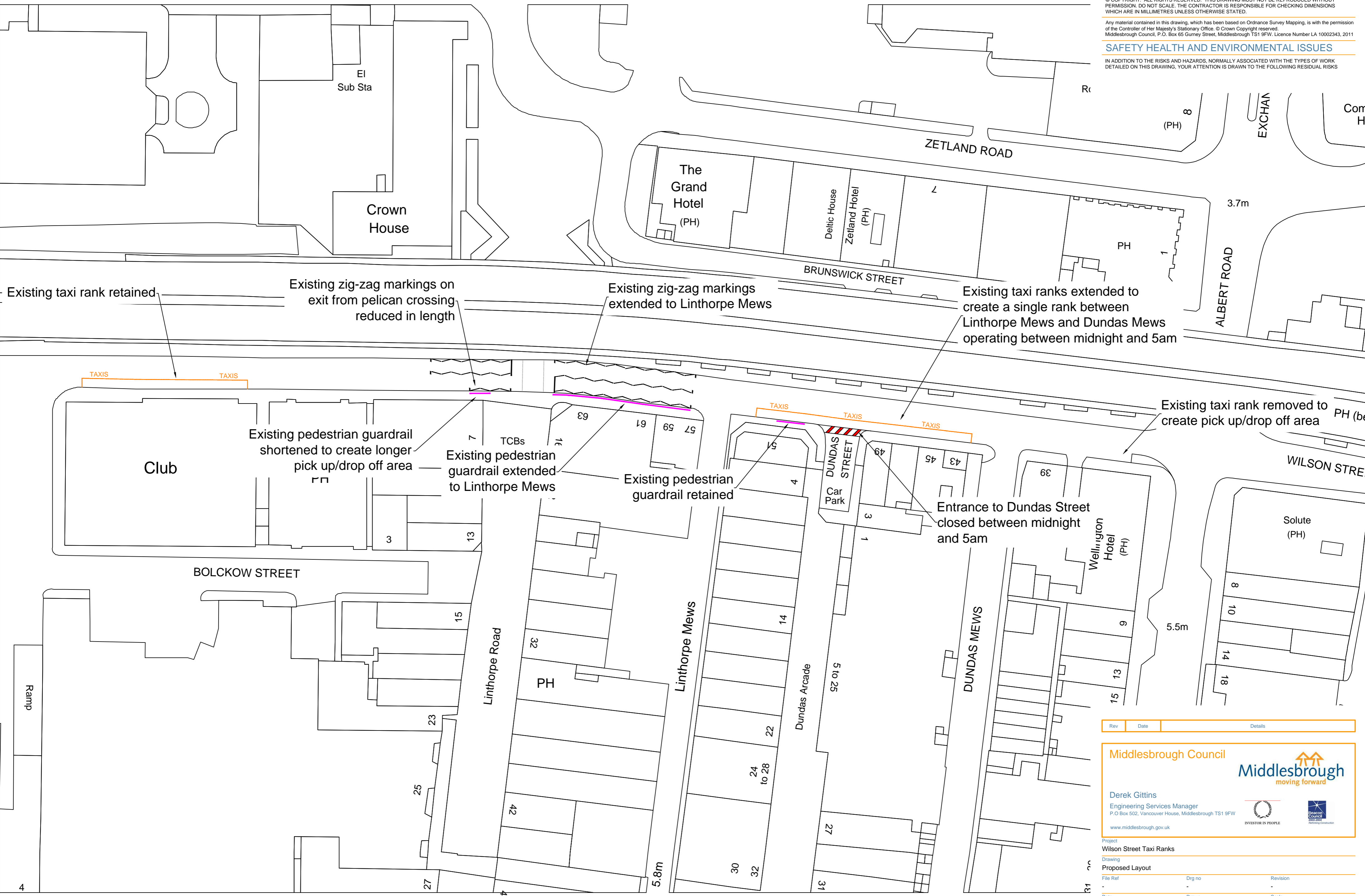

Existing taxi rank retained

Existing zig-zag markings on exit from pelican crossing reduced in length

Existing zig-zag markings extended to Linthorpe Mews

Existing taxi ranks extended to create a single rank between Linthorpe Mews and Dundas Mews operating between midnight and 5am

Existing taxi rank removed to create pick up/drop off area

Existing pedestrian guardrail shortened to create longer pick up/drop off area

Existing pedestrian guardrail extended to Linthorpe Mews

Existing pedestrian guardrail retained

Entrance to Dundas Street closed between midnight and 5am

Rev	Date	Details

**Middlesbrough Council**  
  
 Derek Gittins  
 Engineering Services Manager  
 P.O. Box 502, Vancouver House, Middlesbrough TS1 9FW  
[www.middlesbrough.gov.uk](http://www.middlesbrough.gov.uk)

INVESTOR IN PEOPLE

Project  
Wilson Street Taxi Ranks

Drawing  
Proposed Layout

File Ref	Drg no	Revision
-	-	-

Date	Drawn	Scale	
April 2012	JR	1:500	A2

Tender Reference Number